



**imagine**  
**PURSUE. SERVE. TEACH.**

**Imagine**



# IT IS TIME!

---

Many of us have been waiting for this day for a long time and we believe it is time to take a significant step of faith as a church family and build our permanent church home. When we started Epic, God put Ephesians 3:20 on our hearts:

*"NOW ALL GLORY TO GOD, WHO IS ABLE, THROUGH HIS MIGHTY POWER AT WORK WITHIN US, TO ACCOMPLISH INFINITELY MORE THAN WE MIGHT ASK OR THINK (IMAGINE)."*

God has accomplished more than we could ask or think since Epic began in 2009. And we believe He is going to do that again through IMAGINE!

We know that the only way for IMAGINE to be fulfilled is for all of us to come together to accomplish this mission. Our Elders, Staff, and Tammy and I have gone first in committing financially to our IMAGINE initiatives.

Whether you are new to Epic or have been at Epic for a long time, would you prayerfully read through this packet and ask God, "How do you want me to be a part of IMAGINE?" Envision looking back together years from now and saying "God did more than we could ask or think to reach Flagler County and beyond. And He used us—He used me."

Let's imagine together!



**TRENT SCHAKE**  
LEAD PASTOR



**TAMMY SCHAKE**  
EXECUTIVE DIRECTOR OF  
CHILDREN'S MINISTRY



**imagine**  
**PURSUE. SERVE. TEACH.**



# TABLE OF CONTENTS

**05** COME & SEE

**07** IMAGINE: PURSUE, SERVE, TEACH

**09** WELCOME HOME, EPIC!

**13** ONE FUND APPROACH

**15** PATHWAY TO GENEROSITY

**17** WILL YOU JOIN US?

**21** FREQUENTLY ASKED QUESTIONS

**23** IMAGINE. . .30 YEARS FROM NOW

# COME & SEE

Whether you're new at Epic or have been here since the beginning, God has been doing some amazing things in and through Epic to show our community that He is for them! In this last season, God has been preparing the groundwork for us to do even more together. Take a moment to come and see who Epic is and what God has been doing.

## WHO EPIC IS

**OUR MISSION**...is to lead people into a life-changing relationship with Jesus Christ.

**OUR VISION**...is to reach people for Jesus by being a church for people who don't do church.

**OUR MESSAGE**...is that God is for you and so are we.

**OUR STRATEGY**...is living the 5G life. (God > Gather > Grow > Give > Go)

## WHAT GOD HAS DONE

**IN 2020, WE STARTED THE "FOR FLAGLER" INITIATIVE. GOD LED US TO BE:**

**FOR OUR COMMUNITY** – by creating a Care Network and Counseling Center for Flagler.

**FOR OUR FAMILIES** – by hiring a full-time Student Director and children's ministry staff to serve the next generation.

**FOR THE FUTURE** –by purchasing the land for Epic's future home. Commitment Sunday was March 1, 2020 for this initiative. Then, two weeks later, we had our last live service at Buddy Taylor Middle School before we began exclusively having online services during the COVID outbreak. We thought COVID was going to end our initiatives, but God was faithful and did more than we could ask or think!

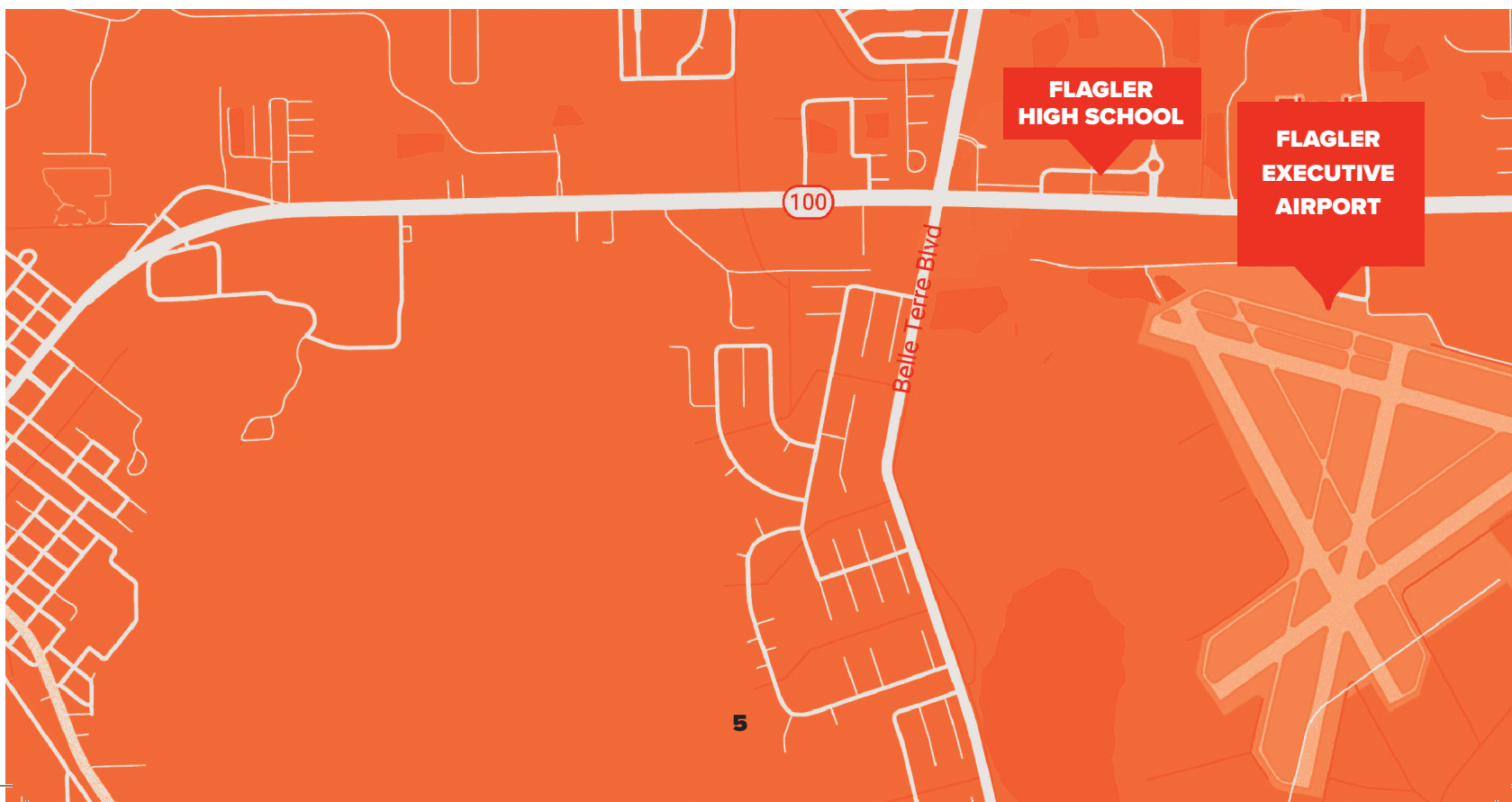

Our goal was to raise \$2.5 million over two years - and our church family committed to give \$2.8 million.

Of the \$2.8 million, we needed \$650,000 in cash gifts to close on the land for Epic's future home. On May 25, 2020, we closed on the 16-acre piece of land on Seminole Woods Boulevard in cash! \$650,009.86 was given in cash gifts—we met the goal with \$9.86 to spare! Every gift mattered!

Then on April 3, 2022, after the two-year For Flagler initiative ended, we celebrated that our church family gave \$3.8 million, exceeding the original goal by 1.3 million!

We say together "Now all glory to God, who is able, through his mighty power at work within us, to accomplish infinitely more than we might ask or think." (Ephesians 3:20)

## **GOD ANSWERED**

**GOD CERTAINLY ANSWERED OUR EPHESIANS 3:20 PROMISE BY DOING MORE THAN WE COULD ASK OR THINK.**

**OUR GOAL - \$2.5 MILLION**

**COMMITTED - \$2.8 MILLION**

**ACTUALLY GIVEN - \$3.8 MILLION**

**ADVENT HEALTH  
HOSPITAL**

**FUTURE SITE OF  
EPIC  
CHURCH**

**SO NOW GOD IS  
INVITING US TO  
REACH MORE  
PEOPLE FOR HIM.**

# imagine

## PURSUE. SERVE. TEACH.

Over 2,000 years ago, Jesus stepped into a world in crisis. Political turmoil and racial tension were high. Poverty and physical needs were great. Violence, hatred, and division were everywhere. The future was uncertain, and people were desperately searching for answers. In response, Jesus came. He brought answers by pursuing, serving, and teaching people.

He went all over Israel—showing everyone that God is for them—not against them. He walked all over the countryside, meeting people’s physical, emotional, and spiritual needs, and He gathered people in small groups and large groups to teach them how to live in a real relationship with a good God. As a result, millions of lives have been transformed and our world will never be the same.

### CALLED TO ANSWER

Today, our world is in crisis again. Political turmoil and racial tension are high. Poverty and physical needs are great. Violence, hatred, and division are everywhere. The future is uncertain, and people are desperately searching for answers. In response, Jesus is sending us to bring people answers. He wants us to bring answers by pursuing, serving, and teaching people.

### WHAT IS IMAGINE?

With this in mind, we invite you to **IMAGINE** this future with us. **IMAGINE** is a 2-year initiative where we as a church are going to pursue our community and let everyone know that God is for them. We are going to serve people’s needs by expanding our Care and Counseling Ministries. We are going to build a permanent home where we can gather people in small groups and large groups to teach them how to live in a life-changing relationship with Jesus.





# EPHESIANS 3:20

**“GOD IS ABLE, THROUGH HIS MIGHTY POWER AT WORK WITHIN US, TO ACCOMPLISH INFINITELY MORE THAN WE MIGHT ASK OR THINK (IMAGINE).”**

What if God did more than we could ask or even imagine? What could happen if each of us let God work in us and through us? Imagine what could happen if we didn't just watch God at work, but joined Him in His work!

Imagine the lives that will be changed forever when people understand that God is for them and so are we. Imagine how many people's physical, emotional, mental, and spiritual needs will be met through our Care and Counseling ministries. Imagine how having a permanent church home will help us teach people how to live in a life-changing relationship with Jesus. Imagine how a church home will help us reach beyond Flagler County to serve more people in our region.

Imagine the possibilities. Imagine the lives changed for all eternity. Imagine what God can do through you. Imagine what God can do through us.

## OUR VISION FOR THE NEXT TWO YEARS IS TO...



**PURSUE our community to let them know that God is for them.**

- ▶ Expand our For Flagler serving opportunities.
- ▶ Mobilize Relief Teams to meet physical needs in our community.
- ▶ Expand our Faith for Flagler Schools Initiative.



**SERVE our community by meeting real physical, emotional, mental, and spiritual needs.**

- ▶ Expand our Care and Counseling Ministries.
- ▶ Build a Care Team that can support a public ministry.
- ▶ Publicly promote our Care and Counseling Ministries to our community.



**TEACH our community how to live in a life-changing relationship with Jesus and build a permanent church home where we can do that.**

- ▶ Lead 1,500 people to Jesus by the time our building is finished.
- ▶ Help 1,000 people take a next step towards or with God.
- ▶ Secure the necessary funds to build our church home.

**THE VISION GOD HAS GIVEN US IS SO BIG, IT WILL TAKE ALL OF US.**

Over the next 24 months, we are asking all of Epic to join us in bringing our **IMAGINE** initiatives into reality. Would you give to help us reach our goal of \$8.4 million to fulfill this vision? \$3.4 million will increase our operational budget which will enable us to pursue our community and expand our Care and Counseling ministries. \$5 million will help us build phase 1 of our new permanent church home.

We are asking everyone who calls Epic their home or supports our vision to pray, engage, and give in new ways during this season. Imagine the eternal impact our community will experience as we join together to give of our time, talents, and treasures to let them know that God is for them.

# WELCOME HOME, EPIC!

## **IT IS TIME! ARE YOU READY TO SEE THE DREAM?**

This is an epic moment! We have been dreaming and envisioning what Epic's new permanent home will be. Imagine the lives that will be changed forever in this building when people understand that God is for them and so are we. Imagine how having an inviting and engaging church home will help us lead more people into a life-changing relationship with Jesus. Imagine how a church home will help us reach beyond Flagler County to serve more people in our region.

Our new church home will be the place where all Epic ministry starts. It will be the place where we teach children, students, and adults how to live in a life-changing relationship with Jesus. It will be a facility to help us reach more people through local, national, and international missions. Imagine how many people's physical, emotional, mental, and spiritual needs will be met through our Care and Counseling ministries. Epic's permanent home will allow us to put down deep roots in Flagler County to lead people to Jesus for generations.

## **GOD IS LEADING US TO TURN THE DREAM OF OUR CHURCH HOME INTO REALITY BY BUILDING IN PHASES.**

We are planning to build Phase 1 of the dream through our Imagine initiative. If God provides beyond what we could ever ask or imagine, then we will reevaluate and take the right steps toward pursuing Phase 2. The building is designed so that we can build Phase 1 and then add on Phase 2 at any point. So let's ask God to accomplish infinitely more through praying and giving together in the pursuit of this dream!

# PHASE 1

**PHASE 1 OF EPIC'S NEW HOME, WHICH WE PLAN TO BUILD THROUGH THE IMAGINE INITIATIVE.**

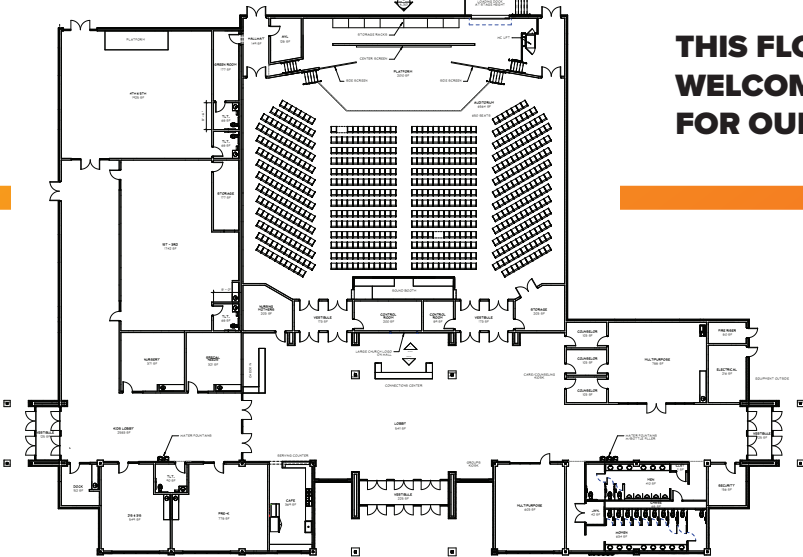

**THIS FLOOR PLAN WILL CREATE A WELCOMING AND INVITING SPACE FOR OUR COMMUNITY.**

**OUR LOBBY WILL MAKE IT EASY FOR EVERYONE TO CONNECT AND PROVIDE EASY ACCESS TO ALL THE MINISTRIES OF EPIC.**



**THE AUDITORIUM WILL HELP TO LEAD PEOPLE INTO A LIFE-CHANGING RELATIONSHIP WITH JESUS.**

**CHILDREN WILL HAVE A PLACE THAT WILL BE FUN, KID-FRIENDLY, AND SAFE.**



**STUDENTS WILL HAVE A PLACE TO BE FULLY ENGAGED!**

## **DREAM BUILDING**

**HERE IS THE FULL DREAM OF WHAT EPIC WILL LOOK LIKE ONE DAY. WE'RE EXCITED AS IT WILL GIVE ALL OUR MINISTRIES THE FULL CAPACITY OF WHAT THEY NEED TO REACH OUR COMMUNITY!**

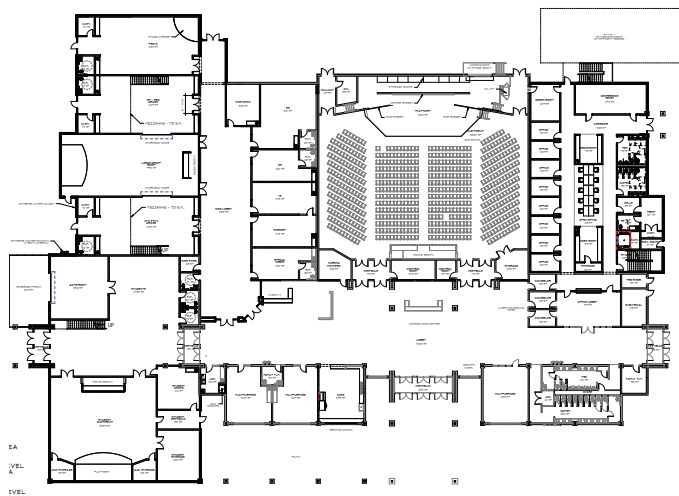

**BIRTH THROUGH 5TH GRADE WILL HAVE ENOUGH ROOMS TO FULLY DO MINISTRY SUCH AS THIS SMALL GROUP ROOM.**



**STUDENTS WILL HAVE A NEW HOME THAT CONNECTS TO THE LOBBY AND GIVES THEM A PLACE TO BELONG.**

**SEE MORE OF THE DREAM!**

**IF YOU WOULD LIKE TO SEE MORE RENDERINGS OF PHASE 1 AND THE DREAM, THEN SCAN THE QR CODE WHICH WILL TAKE YOU TO OUR WEBSITE TO SEE ALL THE RENDERINGS.**





## **ONE FUND APPROACH:**

### **HOW WILL THIS GIVING INITIATIVE WORK?**

You may be thinking, “Wow, that’s a big and exciting vision! I believe in this vision! I want to give to IMAGINE, but how does that work with my normal giving to Epic?” Great question! We are going to utilize a “One Fund” approach to giving to the IMAGINE initiative.

### **HERE’S HOW THAT WORKS...**

In the past, you may have participated in church campaigns in which you were asked to give a second gift “above and beyond” your usual tithe (10%) to make a new facility possible. Normally, you gave that above-and-beyond gift to a “Building Fund” as you also continued to give to the “General Fund.”

This two-fund approach often paralyzes a growing ministry because as money is given for a new facility, then the ongoing ministries suffer as operational budgets remain the same. Or, sometimes people give their tithe to the Building Fund, which hurts the ongoing ministries supported through the General Fund. Although some goals may be reached, often the ongoing ministries and operations of the church suffer.



## **WE BELIEVE A BETTER APPROACH IS A “ONE FUND” APPROACH.**

A “One Fund” approach asks everyone to participate by pausing and evaluating what God is calling them to give through the local church at this critical juncture. Yes, we need to raise funds to build Epic’s permanent home, but we also are not stopping our call to reach Flagler and beyond for Christ!

So, we are asking everyone who makes Epic their home to give towards the IMAGINE initiative over the next two years through one fund—the General Fund. The General Fund accounts for both the ongoing operational budget and the IMAGINE initiative to pursue, serve, and teach our community.

We want to see what God can do when we follow His plan of giving on a regular basis through tithing and above-and-beyond giving to see sustained momentum across all of Epic. This way we can continue to lead more people into a life-changing relationship with Jesus as we build Epic’s permanent home.

# PATHWAY TO GENEROSITY

We are asking everyone who calls Epic their home to pray, engage, and give in new ways during the IMAGINE initiative. The Pathway to Generosity is a tool designed to help each of us focus on the attitude of our hearts. Each stage represents growth in a lifestyle of generosity. These are not steps you ascend to get closer to God, but they are a simple way for you to evaluate your personal growth in generosity.

*GOD'S PLAN FOR GENEROSITY IS A JOURNEY OF TRUSTING HIM WITH ALL WE ARE AND ALL THAT WE HAVE. THE APOSTLE PAUL ENCOURAGES US TO GROW IN EVERY ASPECT OF OUR WALK WITH JESUS, INCLUDING THE GRACIOUS ACT OF GIVING.*

**2**  
**CORINTHIANS**  
**8:7**

## FIRST TIME

Maybe you've not yet given to God at Epic Church. Would you take the next step and begin giving regularly?

## PERCENTAGE

Maybe you've given occasionally, or you give regularly. Accept the challenge to give in the same way you budget for other expenses—consistent percentages of your income. Would you begin to give regularly at a set amount each month?

## TITHING

What if you accepted the biblical challenge to test God's faithful character by giving 10% of your income (tithe) consistently each month (Malachi 3:10)?

## INTENTIONAL

Are you currently tithing? What might a step of intentional generosity look like for you? Would you consider increasing your giving beyond your comfort zone to an even greater percentage?

## LEGACY

Perhaps you are already giving beyond your tithe at Epic Church, but you want to give beyond that to make a kingdom impact that will outlive you. What would that look like for the next year? Two years and beyond?

**CONSIDER:** Wherever you are on the Pathway to Generosity, consider additional resources God has blessed you with (like possessions, assets, savings, stocks, etc.) that He might be asking you to give to His work through Epic Church.



# AS YOU CONSIDER YOUR NEXT STEP, WE ENCOURAGE YOU TO:



## **LISTEN TO GOD**

Prayerfully seek God's guidance as you consider your next step. (Matthew 7:7-8)



## **EVALUATE YOUR RESOURCES**

Consider that everything God has blessed you with ultimately belongs to Him. (Matthew 25:14-30)



## **GET SPECIFIC**

Determine specifically how your resources can be used by God to further His kingdom. (2 Corinthians 9:7)



## **WALK BY FAITH**

Determine your next step, and trust God to grow your faith as you do so. (Malachi 3:10)

# WILL YOU JOIN US?

**NOW THAT YOU'VE HEARD ABOUT EPIC'S IMAGINE INITIATIVES TO:**



## **PURSUE**

our community to let them know that God is for them,



## **SERVE**

our community by meeting real physical, emotional, mental, and spiritual needs,



## **TEACH**

our community how to live in a life-changing relationship with Jesus and build a permanent church home where we can do that,

... we hope you want to join us in this God-sized vision!



We are asking all of Epic to join us in bringing our IMAGINE initiatives to reality by financially supporting it over the next 24 months.

Would you give toward our goal of \$8.4 million to fulfill this vision?

- \$3.4 million will increase our operational budget which will enable us to pursue our community and serve our community through expanding our Care and Counseling ministries.
- \$5 million will help us build phase 1 of our new permanent church home where we can teach people how to live in a life-changing relationship with Jesus.



## AS YOU CONSIDER THIS VISION, ASK GOD:

How do You want me to be a part of this IMAGINE initiative?

How do You want me to grow in giving through IMAGINE?

How do You want to stretch my faith through participating in IMAGINE?

Let's join together in this next chapter of Epic's story and IMAGINE what God can do to lead people into a life-changing relationship with Jesus through our generosity!

**INTENTION CARD**

Once you have spent time with God prayerfully seeking His guidance, please fill out your Intention Card and turn it in on Commitment Sunday, October 15, 2023. This will allow us to know the intentions of everyone who is joining us in the IMAGINE initiative.

**NEW AT EPIC?**

If you are new to Epic and might miss the services on October 15, 2023, you can still participate by watching the IMAGINE message series at [theepicchurch.com](http://theepicchurch.com) and turning in your Intention Card through the giving boxes. Or, mail in your Intention Card to 160 Cypress Point Parkway #C107, Palm Coast, FL 32164.

**EPIC CHURCH'S GENEROSITY GOALS:**

100% engagement of all who call Epic home  
\$8 million over two years (operational and initiatives)



• **PURSUE** our community to let them know that God is for them.



• **SERVE** our community by meeting real physical, emotional, mental, and spiritual needs.



• **TEACH** our community how to live in a life-changing relationship with Jesus and build a permanent church home where we can do that.

\$  What I/we normally give in a year

+ \$  My/our expanded annual financial giving for Imagine

= \$  x's 2 (years) = \$  (My New Normal)

**PLUS**

Stored Gifts + \$

My/our Total Gift to Imagine (October 2023 – October 2025) = \$

NAME(S):

PHONE:

EMAIL:



**IF YOU HAVE ANY QUESTIONS ABOUT IMAGINE, EMAIL US AT [INFO@THEEPICCHURCH.COM](mailto:INFO@THEEPICCHURCH.COM).**

# FAQ: FREQUENTLY ASKED QUESTIONS

As you are thinking about being a part of IMAGINE, we know you will have questions. We want to make sure that there is great communication during the IMAGINE initiative, so we've created this FAQ to address some of your questions proactively.

If there is a question you have that we have not answered, please contact us at [INFO@THEPICCHURCH.COM](mailto:INFO@THEPICCHURCH.COM). We want to make sure your question is answered.

Also, we would love your help in providing correct information to others. Please read through this information and partner with us in providing accurate answers if you are asked questions. It's our desire that together we can provide the right answers for everyone.

We've identified three areas of questions that people may have about IMAGINE. The next page represents one question from each area. Scan the QR code to go to all the FAQs.



## FAQ: IMAGINE

### WHAT IS THE IMAGINE INITIATIVE?

IMAGINE is a 2-year initiative to launch the next phase of Epic's vision. IMAGINE is where we, as a church, are going to pursue our community and let everyone know that God is for them. We are going to serve people's needs by expanding our Care and Counseling Ministries. We are going to build a permanent home where we can gather people in small groups and large groups to teach them how to live in a life-changing relationship with Jesus. We want everyone who calls Epic home to pray, engage, and give in new ways during this season.

---

## FAQ: GIVING

### WHY DOES THE GOAL OF \$8.4 MILLION INCLUDE THE OPERATIONAL BUDGET?

If people give their normal gifts towards just the Building Fund, then this would hurt Epic's ministry on a regular basis throughout the year. We need the operational budget to continue to be funded for ongoing ministry. To continue leading people into a life-changing relationship with Jesus Christ, the One Fund approach sets our whole church up for success financially.

---

## FAQ: BUILDING

### WHY IS EPIC CHURCH GOING TO BUILD A PERMANENT HOME?

As renters, our position in the schools is inherently temporary and somewhat tenuous. During COVID, Epic was not allowed to meet at Buddy Taylor Middle School for 4 months. Also, during hurricanes the school is often used as a shelter, so we are not allowed to meet. At any point, our local school officials could decide not to rent to us. We believe it is time to build now. Epic purchased 16 acres in 2020 and we believe it is crucial that Epic have its own building. We need a permanent church home in order to provide a stable base for ministry to help us reach Flagler County and to serve more people in our region.

A photograph of three men running on a beach, splashing through shallow water. They are all wearing black t-shirts with the text "#FOR FLAGLER" printed on them. The man in the center has a beard and is raising his right fist in a celebratory gesture. The man on the left is bald and has a goatee. The man on the right has short hair and a goatee. The background shows waves breaking on the shore under a bright, hazy sky. The entire image has a warm, orange-gold color cast.

**IMAGINE . . .**

**30 YEARS FROM NOW . . .**

Whose lives could be different because we, as Epic, pursued people to let them know that God is for them.

What families would be healthy and whole because men and women found the emotional and relational healing they needed through our Care and Counseling Ministry.

What people will be in heaven because they were led to a life-changing relationship with Jesus.





**IMAGINE** . . . your kids and grandkids coming to Epic's permanent church home and growing spiritually.

**IMAGINE** . . . The stories you could tell about the part you played in **IMAGINE**.

What faith story will you share? What story of crazy generosity will you tell?

All because you dared to **IMAGINE!**

## **EPHESIANS 3:20**

***“GOD IS ABLE, THROUGH HIS MIGHTY POWER AT WORK WITHIN US, TO ACCOMPLISH INFINITELY MORE THAN WE MIGHT ASK OR THINK (IMAGINE).”***











***NOW ALL GLORY TO GOD, WHO IS ABLE,  
THROUGH HIS MIGHTY POWER AT WORK  
WITHIN US, TO ACCOMPLISH INFINITELY  
MORE THAN WE MIGHT ASK OR THINK  
(IMAGINE). EPHESIANS 3:20 NLT***





**EPIC**  
CHURCH